



1074 Kenran Industrial Dr.  
St. Louis, MO 63137  
Phone: 1-800-381-9968

# HUMCO DECK FITTINGS

## Jeamar Premium Steel Sheaves

### Premium Steel Sheaves with Ball Bearings

**Jeamar Winches**  
YOUR FIRST CHOICE FOR WINCHING SOLUTIONS

#### High Quality

Jeamar steel sheaves are manufactured from the highest-quality, fine-grain steel, ensuring uniformity of material, consistent high quality and greater strength. The innovative, cold-rolled forming process ensures an ideal groove profile. The inherent elasticity and resilience of steel makes for a tougher sheave to meet the most demanding applications.

#### Work Hardened

Work hardening of the rope groove takes place during the forming process, which substantially increases the life of the sheave. The high-quality finish of the rope groove ensures minimum wear and abrasion between the rope and sheave, adding considerably to the rope life.

#### High Strength And Low Weight

The strength of the steel used considerably exceeds that of cast iron. Steel also has a weight-saving advantage of up to 50 percent over cast iron, resulting in easier handling and installation.

#### Exceptional Arc of Support

Jeamar steel sheaves are designed with a minimum arc of support for the rope of 125 degrees, ensuring that the rope cross sectional shape is maintained under normal load conditions. In turn, this increases rope life by minimizing internal rope flexing and increases sheave life by reducing gouging. Note: It is essential that the correct size of sheave be used for the rope. For instance, a 1/2 in. diameter rope should be used with a sheave that has a 1/2 in. groove radius, to achieve optimum conditions.

#### High Sheave-to-Rope Ratio

Jeamar sheaves have a minimum sheave-to-rope ratio of 15:1. This ensures a large radius for the rope to bend around, which in turn decreases flexing of the rope and substantially increases rope life.

#### High Efficiency Ball or Roller Bearings

Jeamar steel sheaves incorporate either ball or taper roller bearings for maximum efficiency, reduced friction, smooth motion, long life and high speed.

#### Lifetime Lubrication

The ball and roller bearings are sealed and lifetime lubricated for long life and minimum maintenance costs.

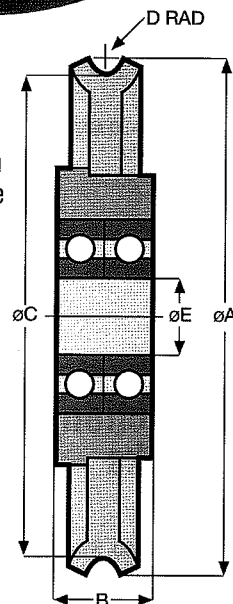

Model Number		S 1000	S 3500	S 7000	S 10500	S 16000	S 23000	S 31000	S 41000	S 52000	S 68000	S 83000
Working Load Limit	lb	1000	3500	7000	10500	16000	23000	31000	41000	52000	68000	83000
	kg	455	1587	3175	4772	7272	10455	14090	18636	23583	30839	37642
Sheave Diameter	in	2.25	4.25	6.00	8.00	10.00	12.00	14.00	16.00	21.54	23.54	26.34
	mm	57	109	152	203	254	305	357	406	547	598	669
Rope Size	in	1/8	1/4	3/8	1/2	5/8	3/4	7/8	1	1 1/8	1 1/4	1 3/8
	mm	3	6	10	13	16	19	22	25	29	32	35
Weight	lb	3	3.5	6	10	16	24	38	56	114	182	300
	kg	1.3	1.6	2.7	4.5	7.3	10.9	17.2	25.4	52	83	136
DIMENSIONS (mm)	A	57	109	152	203	254	305	357	406	547	598	669
	B	20	30	38	42	50	58	66	74	67	67	80
	C	51	95	136	179	222	265	313	362	457	508	559
	D	2	3.5	5.5	6.5	9.5	11.5	11.5	13.5	16	17	19
	E	12	20	30	35	45	55	65	75	90	100	110

The S 52000, S 68000 and S 83000 are supplied with double row cylindrical roller bearings.



1074 Kenran Industrial Dr.  
St. Louis, MO 63137  
Phone: 1-800-381-9968

# HUMCO DECK FITTINGS

## Jeamar Sheaves & Blocks

### Jeamar Winches

YOUR FIRST CHOICE FOR WINCHING SOLUTIONS

### Vertical Directional Blocks

The S 52000, S 68000 and S 83000 are supplied with double row cylindrical roller bearings.



### Sheaves & Blocks

Model Number		VB 1000	VB 3500	VB 7000	VB 10500	VB 16000	VB 23000	VB 31000	VB 41000	VB 52000	VB 68000	VB 83000
Working Load Limit	lb	1000	3500	7000	10500	16000	23000	31000	41000	52000	68000	83000
	kg	455	1587	3175	4772	7272	10455	14090	18636	23583	30839	37642
Sheave Diameter	in	2.25	4.25	6.00	8.00	10.00	12.00	14.00	16.00	21.54	23.54	26.34
	mm	57	109	152	203	254	305	357	406	547	598	669
Rope Size	in	1/8	1/4	3/8	1/2	5/8	3/4	7/8	1	1 1/8	1 1/4	1 3/8
	mm	3	6	10	13	16	19	22	25	29	32	35
Weight	lb	2	6	16	27	54	80	128	229	375	595	950
	kg	0.9	2.7	7.25	8.2	24.5	36.3	58	104	170	270	431
DIMENSIONS (mm)	A	57	109	152	203	254	305	357	406	547	598	669
	B	51	95	136	179	222	265	313	362	457	508	559
	C	32	60	83	114	153	216	267	292	406	444	497
	D	51	89	127	165	203	280	330	368	497	543	608
	E	70	87	122	151	185	219	253	286	283	309	346
	F	89	125	167	202	236	283	317	362	359	392	439
	G	35	61	86	112	143	165	194	223	283	309	346
	H	8.75	10.3	13.5	17.5	21	27	27	33	33	35	40
	J	4.75	6.4	9.6	13	16	19	22	26	26	29	32

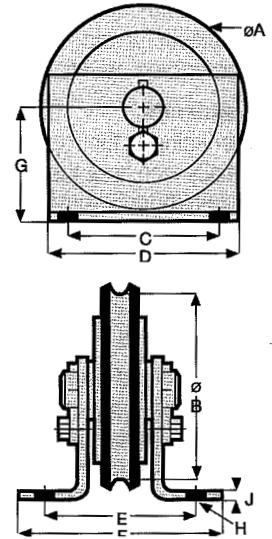

### Horizontal Directional Blocks

The S 52000, S 68000 and S 83000 are supplied with double row cylindrical roller bearings.



Model Number		HB 1000	HB 3500	HB 7000	HB 10500	HB 16000	HB 23000	HB 31000	HB 41000	HB 52000	HB 68000	HB 83000
Working Load Limit	lb	1000	3500	7000	10500	16000	23000	31000	41000	52000	68000	83000
	kg	455	1587	3175	4772	7272	10455	14090	18636	23583	30839	37642
Sheave Diameter	in	2.25	4.25	6.00	8.00	10.00	12.00	14.00	16.00	21.54	23.54	26.34
	mm	57	109	152	203	254	305	357	406	547	598	669
Rope Size	in	1/8	1/4	3/8	1/2	5/8	3/4	7/8	1	1 1/8	1 1/4	1 3/8
	mm	3	6	10	13	16	19	22	25	29	32	35
Weight	lb	5.4	8.3	19	25	66	100	170	316	488	774	1235
	kg	2.45	3.8	8.6	11.4	30	45.4	77	144	221	351	560
DIMENSIONS (mm)	A	57	109	152	203	254	305	357	406	547	598	669
	B	101.6	160	222	286	362	445	514	597	744	813	910
	C	121	184	248	324	413	508	590	660	844	922	1032
	D	51	95	136	179	222	265	313	362	457	508	559
	E	38	76	114	146	178	216	242	305	447	489	547
	F	8.75	9	13	17	20	27	33	40	40	44	49
	G	57	102	140	184	229	279	318	368	547	598	669
	H	44.5	70	102	121	146	165	203	223	168	184	206
	J	16	25	33	38	45	52	60	67	65	71	80
	K	4.75	6	10	13	16	19	22	25	25	29	32

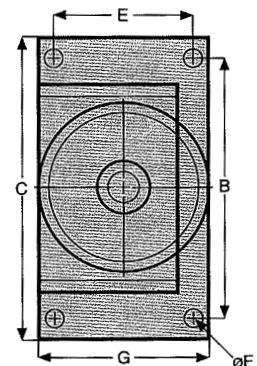
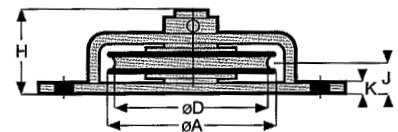



1074 Kenran Industrial Dr.  
St. Louis, MO 63137  
Phone: 1-800-381-9968

# HUMCO DECK FITTINGS

## Jeamar Sheaves & Blocks

### Jeamar Winches

YOUR FIRST CHOICE FOR WINCHING SOLUTIONS

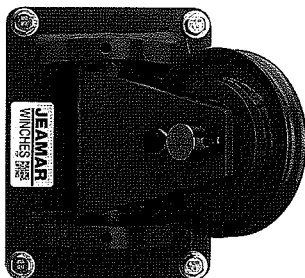

### Sheaves & Blocks

#### Single Swivel Directional Blocks

Model Number		SS 3500	SS 7000	SS 10500	SS 16000	SS 23000	SS 31000	SS 41000	SS 52000	SS 68000	SS 83000
Working Load Limit	lb	3500	7000	10500	16000	23000	31000	41000	52000	68000	83000
	kg	1587	3175	4772	7272	10455	14090	18636	23583	30839	37642
Sheave Diameter	in	4.25	6.00	8.00	10.00	12.00	14.00	16.00	21.54	23.54	26.34
	mm	109	152	203	254	305	357	406	547	598	669
Rope Size	in	1/4	3/8	1/2	5/8	3/4	7/8	1	1 1/8	1 1/4	1 3/8
	mm	6	10	13	16	19	22	25	29	32	35
Weight	lb	10	25	40	121	180	290	450	645	1104	1768
	kg	4.5	11.3	18.1	55	82	132	204	293	501	802
DIMENSIONS (m m)	A	109	152	203	254	305	357	406	547	598	669
	B	95	136	179	222	265	313	362	457	508	559
	C	120	183	243	305	360	420	480	483	515	582
	D	135	246	269	330	395	450	520	649	709	792
	E	90	150	180	225	270	320	360	406	432	489
	F	100	215	200	250	300	350	400	572	622	699
	G	6	10	12	16	20	20	25	25	29	32
	H	115	185	214	268	320	376	428	483	533	592
	J	12	14	14	16	20	26	33	33	36	40
	K	36	54	72	75	104	130	144	144	157	176

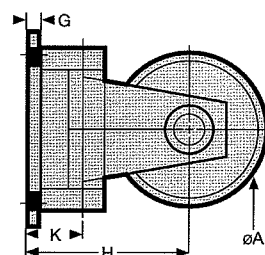
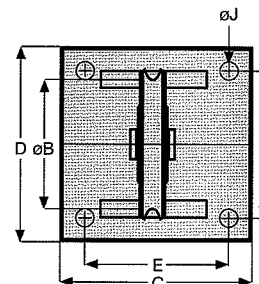

The S 52000, S 68000 and S 83000 are supplied with double row cylindrical roller bearings.

#### Fairlead Assemblies

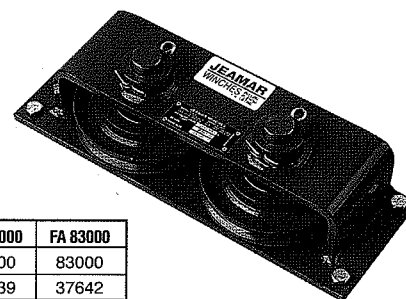
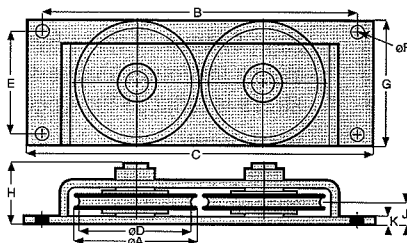

Model Number		FA 3500	FA 7000	FA 10500	FA 16000	FA 23000	FA 31000	FA 41000	FA 52000	FA 68000	FA 83000
Working Load Limit	lb	3500	7000	10500	16000	23000	31000	41000	52000	68000	83000
	kg	1587	3175	4772	7272	10455	14090	18636	23583	30839	37642
Sheave Diameter	in	4.25	6.00	8.00	10.00	12.00	14.00	16.00	21.54	23.54	26.34
	mm	109	152	203	254	305	357	406	547	598	669
Rope Size	in	1/4	3/8	1/2	5/8	3/4	7/8	1	1 1/8	1 1/4	1 3/8
	mm	6	10	13	16	19	22	25	29	32	35
Weight	lb	14.8	26.5	44	117	177	300	560	645	1104	1768
	kg	6.7	12	20	53	80	136	254	293	501	802
DIMENSIONS (m m)	A	109	152	203	254	305	357	406	547	598	669
	B	272	380	496	625	760	880	1016	1304	1424	1592
	C	296	406	534	676	825	956	1096	1404	1533	1714
	D	95	136	179	222	265	313	362	457	508	559
	E	76	114	146	178	216	242	305	447	489	547
	F	9	13	17	20	27	33	40	40	44	49
	G	102	140	184	229	279	318	368	547	598	669
	H	70	102	121	146	165	203	223	168	184	206
	J	25	33	38	45	52	60	67	65	71	80
	K	6	10	13	16	19	22	25	25	29	32

The S 52000, S 68000 and S 83000 are supplied with double row cylindrical roller bearings.

## Jeamar Sheaves & Blocks

### Sheaves & Blocks

**Jeamar Winches**  
YOUR FIRST CHOICE FOR WINCHING SOLUTIONS

#### Snatch Blocks

##### Taper Roller Bearings

Taper roller bearings with a high side load capacity are standard in Jeamar snatch blocks. These bearings overcome the side loads imposed during the initial tensioning of the wire rope, extending the life and increasing the efficiency of the snatch block.

##### Easy Installation

The drop side is secured by a simple non-removable attachment with an additional 'secure pin'. The design allows the rope to be installed and removed quickly and easily.

##### Block loading

Jeamar blocks are rated for the full working load limit at 0° rope angle.

##### High Quality

Jeamar steel sheaves are precision made from the highest quality fine-grain steel. They're tough, hassle free and they last longer.

##### High Strength and Low Weight

The strength of the steel used by Jeamar considerably exceeds that of cast iron. Steel also has a weight-saving advantage of up to 50 percent over cast iron, resulting in easier handling and installation.

##### Exceptional Arc of Support

Jeamar steel sheaves ensure that the shape of your rope is maintained under normal load conditions.

##### High Sheave-to-Rope Ratio

With a minimum sheave-to-rope ratio of 15:1, the rope's bending stress is reduced for longer life.

##### Work Hardened

Rope grooves are hardened during forming, increasing the life of sheave and rope.

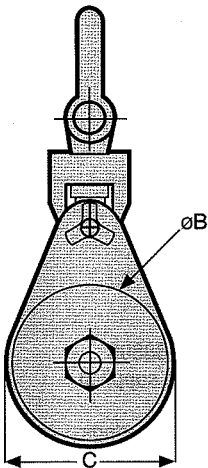
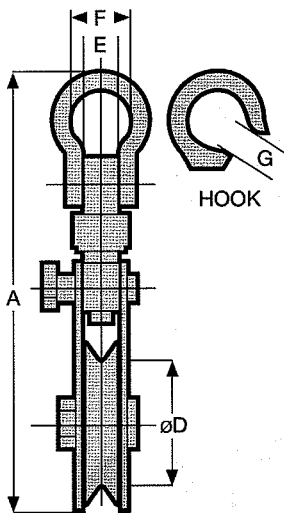

Model Number		SB 3500	SB 7000	SB 10500	SB 16000	SB 23000	SB 31000	SB 41000
Working Load Limit	lb	3500	7000	10500	16000	23000	31000	41000
	kg	1587	3175	4772	7272	10455	14090	18636
Sheave Diameter	in	4.5	6.00	8.00	10.00	12.00	14.00	16.00
	mm	114	152	203	254	305	356	406
Rope Size	in	1/4	3/8	1/2	5/8	3/4	7/8	1
	mm	6	10	13	16	19	22	25
Weight	lb	10	15	20	40	75	88	107
	kg	4.5	6.8	8.6	18	34	40	48.5
DIMENSIONS (mm)	A	330	372	423	584	635	788	854
	B	114	152	203	254	305	356	407
	C	121	159	210	261	311	365	416
	D	103	136	179	222	265	313	362
	E	27	27	27	44	59	59	59
	F	42	42	42	68.5	89	89	89
	G	37	37	36	48	53	53	53